

CONCEPT^{EN}

X-Series

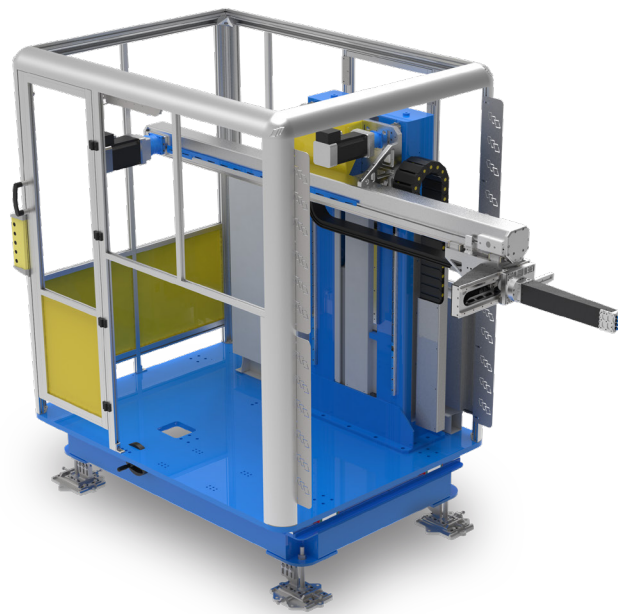

CAMPETELLA

Side entry robot CONCEPT X-Series ev0

 *Campetella,
the right way
to save energy.*

FOLLOW US:



Xseries
EVO

CONCEPT X-Series evo

Redefines the concept of side-entry in multi-cavity applications

Characterised by ingenious and revolutionary mechanics, Concept X-Series is a game changer when it comes to the concept of productivity in the world of high-speed side-entry robots. Perfect with the use of voluminous pick-up hands, it is unbeatable in the most extreme applications with high number of cavities of light parts.

Axis C servo-driven with cam-operated mechanism
Maximum load capacity 15 kg

Self-lubricating sliding blocks with roll-by balls on carbon steel prismatic guides



Console EVO

Light and ergonomic, with a 7" TFT 800x480 wide range touch screen and a membrane keyboard, it allows to program and manage all the robot functions in a simple and intuitive way.

Through a simple wizard, it quickly guides the user through the creation of IMM unloading cycles with palletizing functions. In order to encourage more complex work cycles, we use a powerful editor, which allows to access all the available functions. The EVO software offline version is also available to be installed on a PC in order to permit the offline programming and the remote connection to the robot.

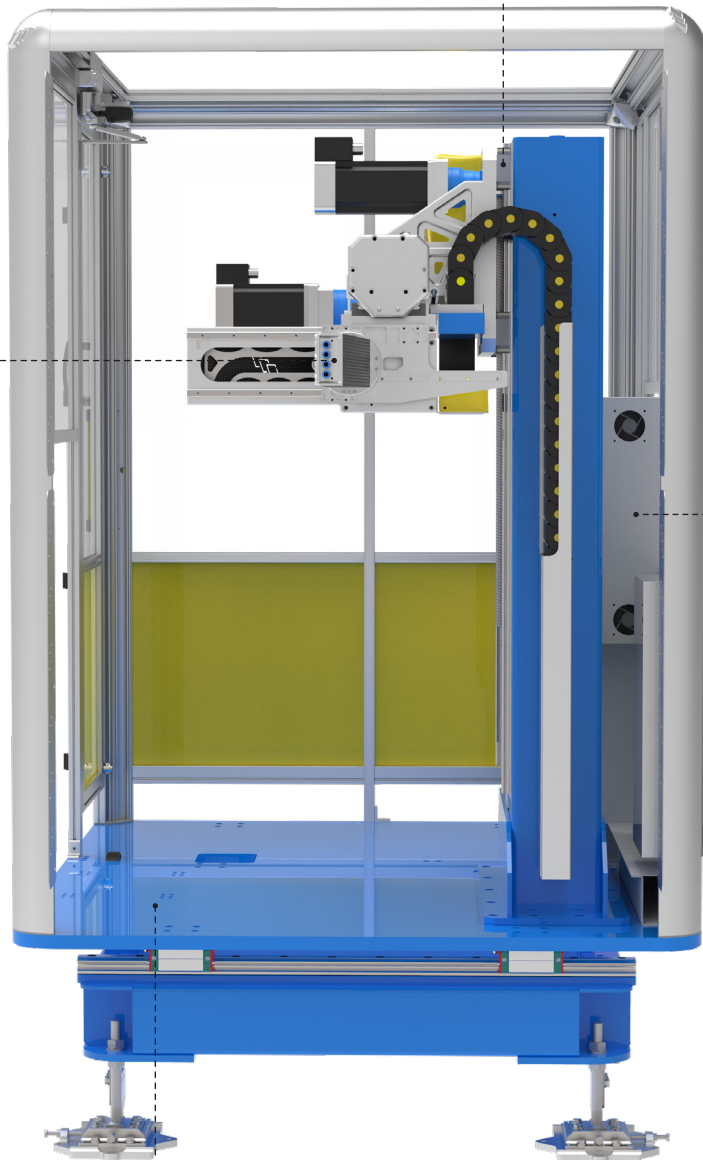

Sturdy base for resting on floor

Electrical panel on board

CONCEPT X-Series evo

CONCEPT

Technical specifications

Maximum payload [kg]:	15
Vertical axis:	Direct
Vertical axis pneumatic balancing:	•
Z-axis stroke - Horizontal [mm]:	2520
X Axis stroke - Extraction [mm] (linear section / at end of C axis rotation)	150/290
Y-axis stroke - Vertical [mm]:	670
X, Y, Z axes motion:	Servomotori AC brushless sincroni
X,Y,Z axes guidance system:	Pattini autolubrificanti a ricircolo di sfere su guide prismatiche in acciaio temprato
Positioning repeatability [mm]:	± 0,1
Gripping system rotation [deg]:	0°/90°
Control unit:	Sistema proprietario Competella EVO
Minimum cycle time with maximum load [s]:	4,0
Electrical power supply:	400-480 VAC • 50-60Hz • 3P+T
Installed electrical power [kVA]:	25
Pneumatic power supply [bar]:	6
Peso indicativo [kg]:	1200

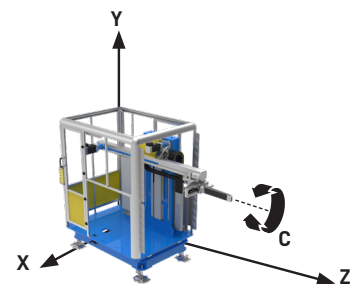
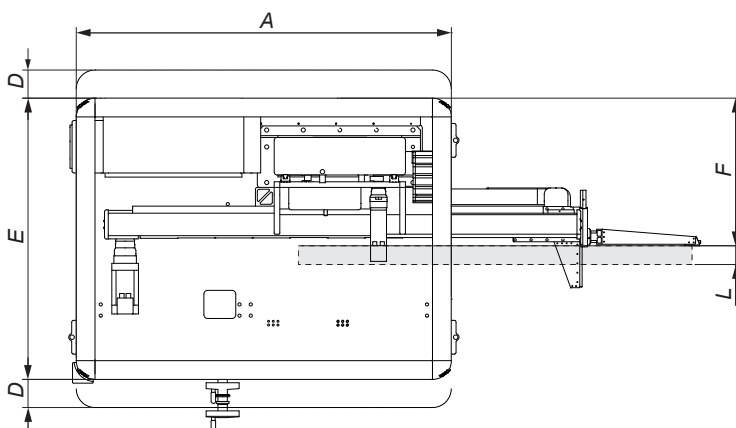
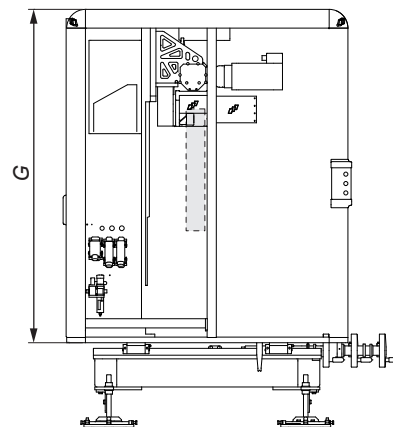
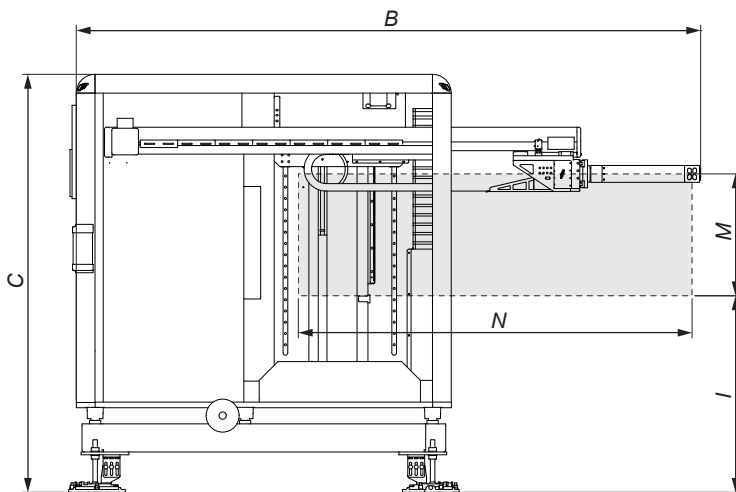

Model	A	B	C	D	E	F	G	H	I	L	M	N
CONCEPT	2000	3730	2230	150	1500	790	1780	1050	N/A	150	650	2500

CONCEPT

Wrist

C servo-driven with cam-operated mechanism (1)

●

(1) The rotation occurs at the end of the extraction movement - X axis

Gripping system Pneumatics

4 vacuum lines with release blows

●

First pressure circuit for mechanical gripper

●

Additional vacuum circuits with release blows

-

Additional pressure circuits for mechanical gripper

-

Electronics and Software

Euromap 67 interface

●

Ethernet interface

●

USB interface

●

Socket for digital signals on the wrist: 5 (Programmable Input/ Output) *

●

Socket for user safety signals

-

Socket for conveyor belt signals: 1 (Input) + 2 (Output) + 1 (Relais Output)

●

Socket for digital signals: 4 (Input) + 3 (Output relay)

●

Vertical axis approaching sensor

●

Industry 4.0 kit (ethernet router + software)

○

Board kit I/O external 16I + 16O with 8mt cable

○

Electrical panel on board

●

Electrical cabinet on the ground

-

Ground cabinet air conditioning

○

IML ready with high-voltage cable (high-voltage wiring for IML predisposition)

-

PLC software integrated into the CNC

○

Off-line programming software

○

Steel base with mechanical shifting towards X (max 300 mm):

●

Safety protections with system and interface Euromap 73:

●

* Every additional vacuum line absorbs one I/O

Accessori**IMM connecting cable:**

For Euromap 67 interface, available lengths [m]: 10 (●) 12 (○) 14 (○)

For JIS interface, available lengths [m]: 10 (○)

Pushbutton remote control panel for basic functions (○)**EVO console cable winder (○)**

● Standard ○ Optional - Not available